



HTL INDUSTRIAL TRAFFIC LIGHTS

Model: 300mm (High Flux)

Installation Guide



Index

Introduction	3
C-Bracket Installation Instructions.....	3
Step 1: Preparation:.....	3
Step 2: Installing the Light:	3
Step 3: Mounting the Bracket:	4
Step 4: Light direction adjustment:.....	4
Step 5: Sun Visor Installation:	4
Step 6: Light Dimensions:	4
Step 7: Electrical Connection:	5
L-Bracket Installation Instructions	6
Step 1: Preparation:.....	6
Step 2: Installing the Light:	6
Step 3: Mounting the Bracket:	6
Step 4: Light direction adjustment:.....	6
Step 5: Sun Visor Installation:	7
Step 6: Light Dimensions:	7
Step 6: Electrical Connection:	7
Troubleshooting	8

Introduction



Harding Traffic's industrial traffic lights are the ideal solution for off-street environments. They provide an economical alternative to highway-approved traffic lights without compromising on quality or performance. These lights are perfect for a range of commercial applications, such as warehouses, factories, private roads, and parking facilities.

C-Bracket Installation Instructions

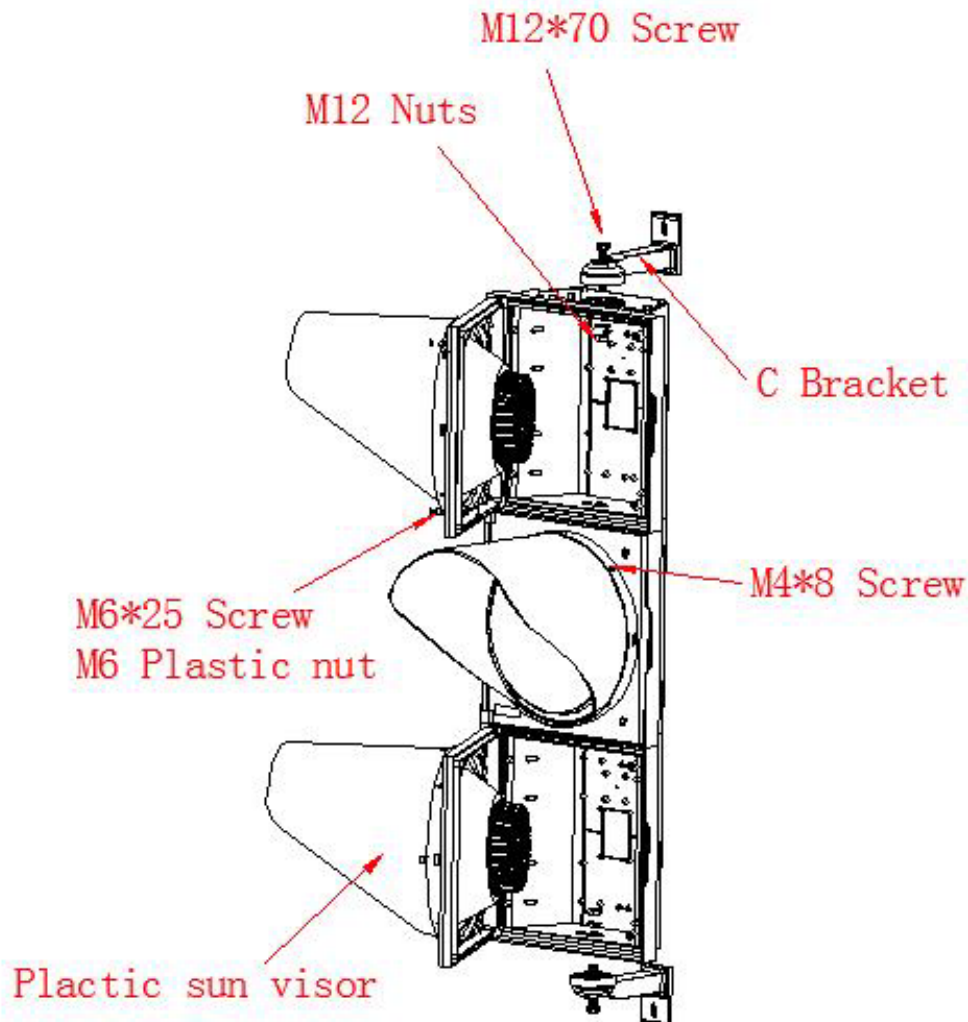

Step 1: Preparation:

1. Ensure all components, including the C bracket, traffic signal modules (Red, Amber, Green), and mounting tools, are accounted for.
2. Confirm that the installation site is stable, safe, and pre-wired for the appropriate voltage (12–24V DC or 110–220V AC).

Step 2: Installing the Light:

1. Attach the light (Red, Amber, Green) to the corresponding slots or holes on the C bracket.
2. Align the modules to ensure they face oncoming traffic at the proper viewing angle.
3. Secure the traffic signal to the C bracket using M12 nuts and bolts.
4. Thread the signal's electrical cable through the entry point in the bracket or pole.

Step 3: Mounting the Bracket:

1. Position the C bracket on the pole or mounting surface, ensuring it aligns correctly with the desired traffic light orientation.
2. Secure the bracket using the bolts or clamps, tightening firmly to prevent movement but avoiding over-tightening to prevent damage.

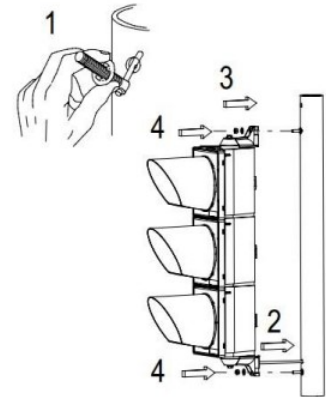

Step 4: Light direction adjustment:

- Loosen the mounting nuts at the top and bottom of the bracket to adjust the light's direction.
- Align the signal to face the desired traffic lane.
- Tighten the nuts securely to hold the alignment.
- Double-check the aiming direction for accuracy.

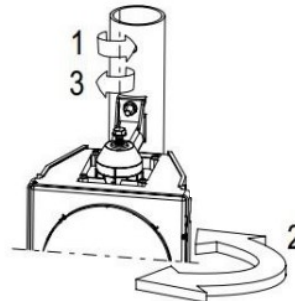

Step 5: Sun Visor Installation:

1. Open the 300mm high flux traffic light.
2. Insert the sun visor directly into the retaining groove of the layout cover before installation.
3. And locked with 2 M4*8 cross semi-circular head-tail screws.

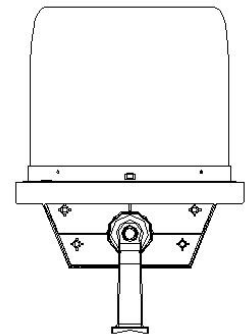

Step 6: Light Dimensions:

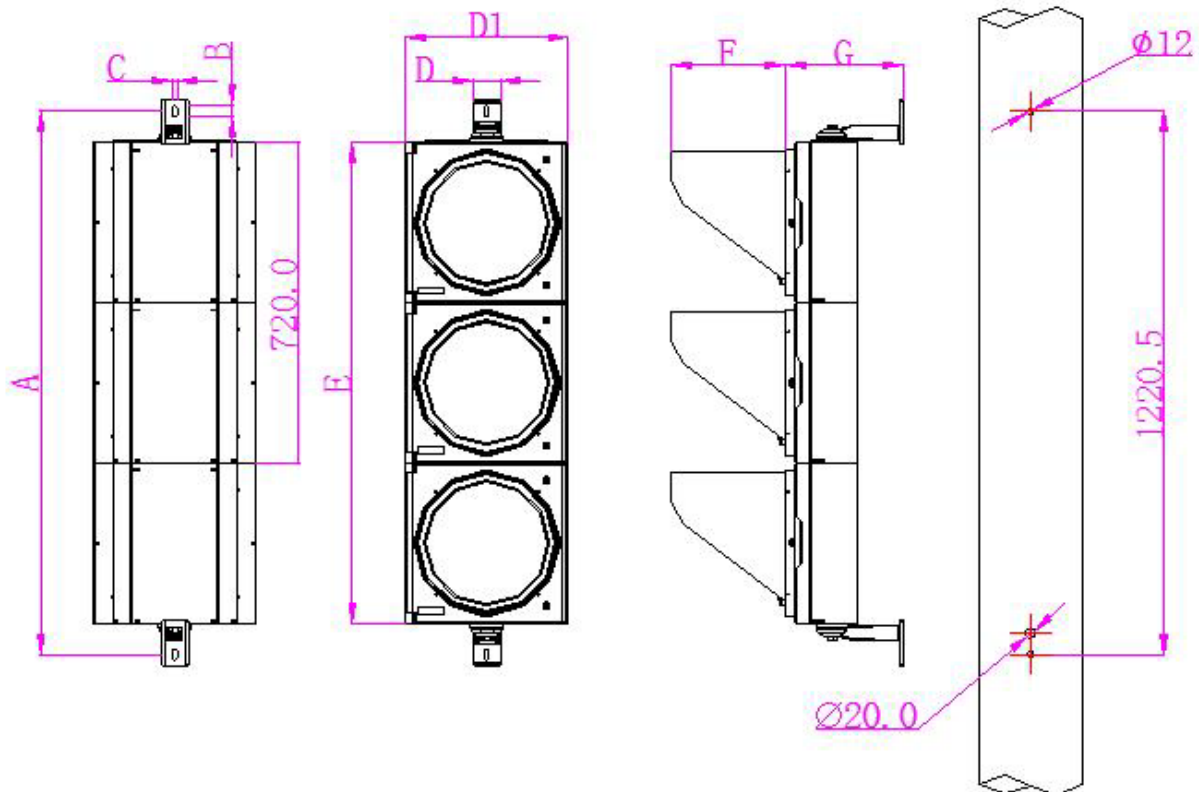

300mm Traffic Light – C-Bracket

DRAWING LOCATION	1 LIGHT ASPECT	2 LIGHT ASPECT	3 LIGHT ASPECT
A	501.5mm	860.5mm	124mm
B	24mm	24mm	24mm
C	10mm	10mm	10mm
D	60mm	60mm	60mm
D1	366mm	366mm	366mm
E	360mm	720mm	1080mm
F	256mm	256mm	256mm
G	268mm	268mm	268mm

Step 7: Electrical Connection:

1. Connect the signal module wiring to the pre-installed electrical system, matching the color-coded wires to their respective terminals (Red, Amber, Green).
2. Ensure connections are insulated and protected from moisture or weather exposure

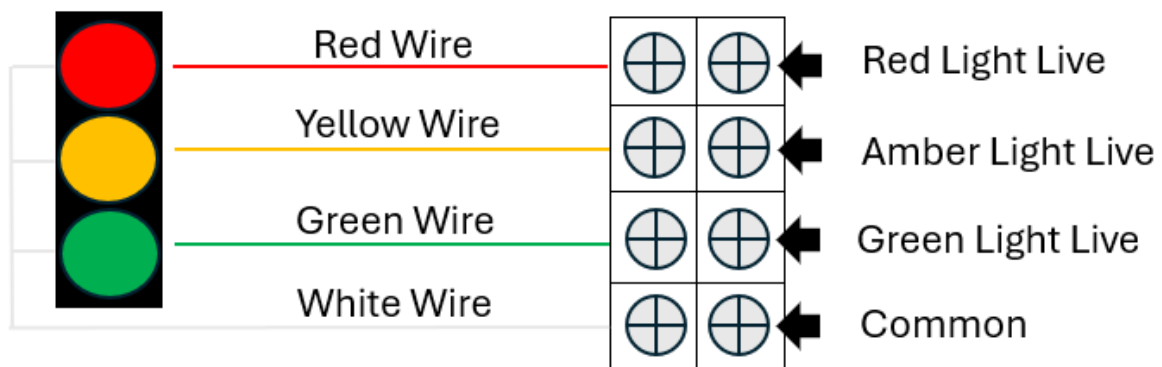

L-Bracket Installation Instructions

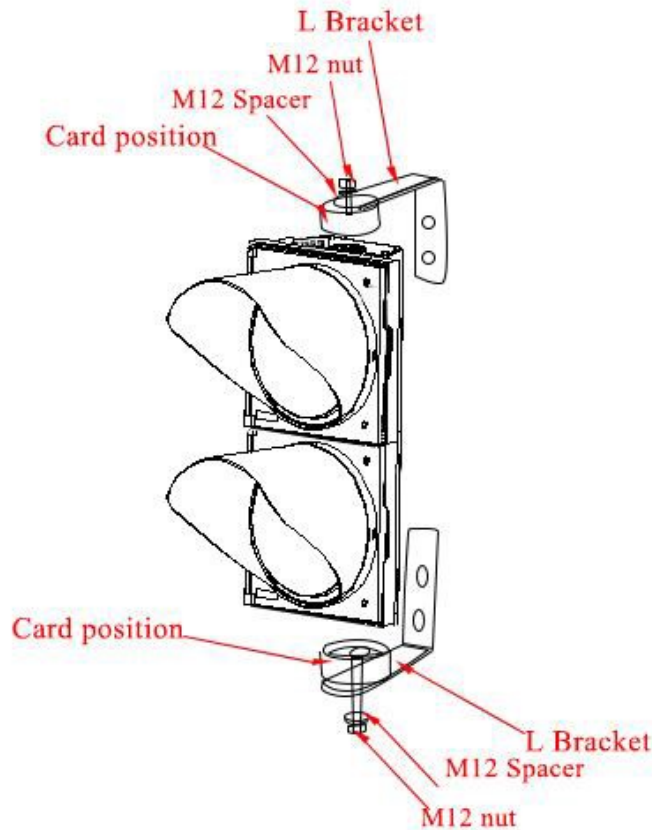

Step 1: Preparation:

1. Confirm all components are included: 300mm traffic signal, L brackets, mounting hardware (M12 gaskets, nuts, and screws), and tools.
2. Verify the voltage requirements (100–277VAC or 12–24VDC) match your power supply

Step 2: Installing the Light:

5. Remove the M12 gasket and nut from the top and bottom of the traffic light.
6. Position the L bracket as shown in the manual illustrations.
7. Reattach the M12 gasket and nut to secure the bracket to the signal.
8. Repeat the process for the second L bracket.

Step 3: Mounting the Bracket:

3. Position the L bracket on the pole or mounting surface, ensuring it aligns correctly with the desired traffic light orientation.
4. Mark the position of the two mounting holes based on the installation diagram.
5. Drill two 12mm diameter holes (or as required for the mounting bolts being used).
6. Attach the L brackets to the pole using the bolts, ensuring a tight fit.

Step 4: Light direction adjustment:

- Loosen the mounting nuts at the top and bottom of the bracket to adjust the light's direction.
- Align the signal to face the desired traffic lane.
- Tighten the nuts securely to hold the alignment.
- Double-check the aiming direction for accuracy.

Step 5: Sun Visor Installation:

4. Open the 300mm high flux traffic light.
5. Insert the sun visor directly into the retaining groove of the layout cover before installation.
6. And locked with 2 M4*8 cross semi-circular head-tail screws.

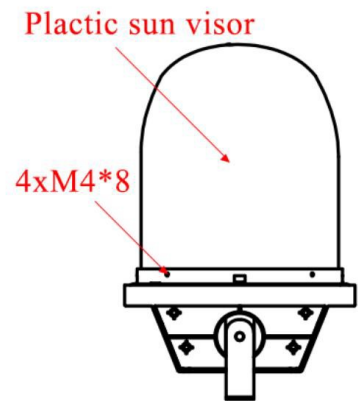

Step 6: Light Dimensions:

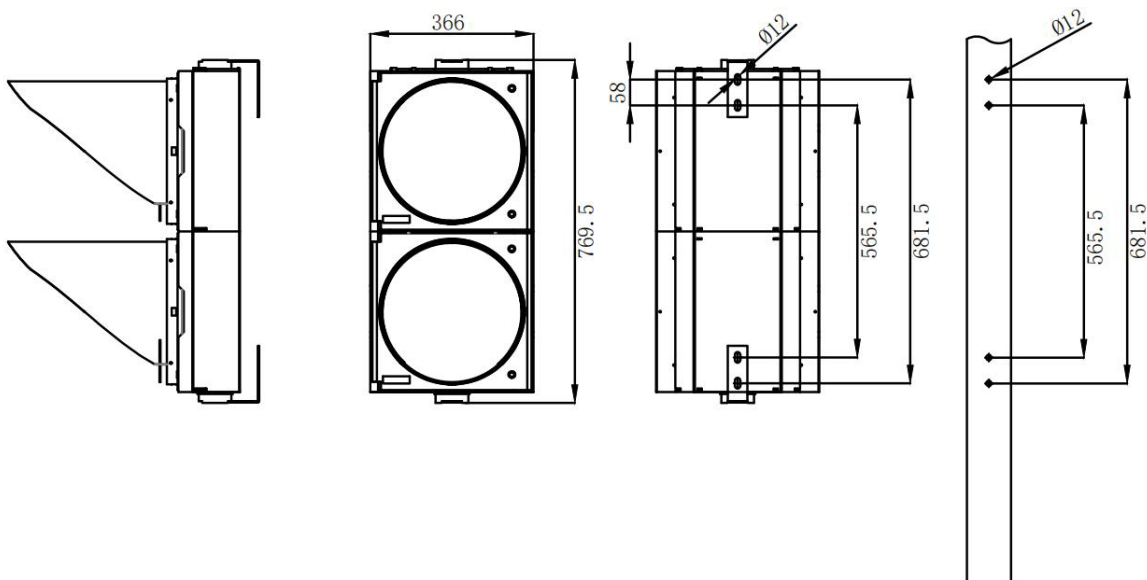

Step 6: Electrical Connection:

3. Connect the signal module wiring to the pre-installed electrical system, matching the color-coded wires to their respective terminals (Red, Amber, Green).
4. Ensure connections are insulated and protected from moisture or weather exposure

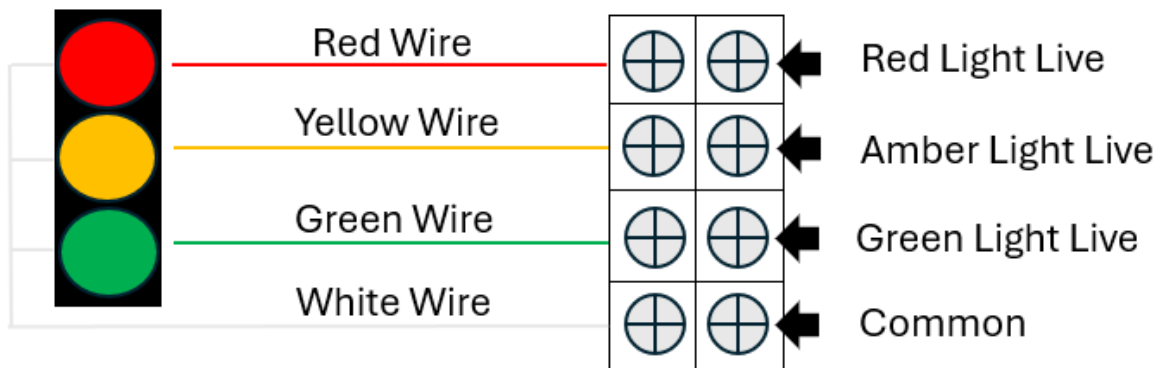

Troubleshooting



Traffic Light Does Not Turn On

- **Check Power Supply:** Verify the operating voltage on the signal label matches the power supply.
- **Inspect Wiring:** Double-check all wire connections for proper placement (live, common)
- **Test Connections:** Ensure all connections are secure and there are no loose cables.
- **Test Components:** If you have a multimeter, check for continuity across the cables and terminals to ensure proper electrical flow.

Traffic Lights Flickering

- **Unstable power supply or voltage drop.** Ensure the power supply is stable and within the required range (100–277V AC or 12–24V DC).
- **Loose wiring connections.** Tighten all electrical connections to eliminate loose contacts.
- **Signal module damaged by environmental factors:** Inspect for water damage or debris inside the module; clean or replace as needed.

If the issue persists after following these steps, please contact Harding Traffic for further assistance at 0800 427 346.